

Chapter 3

Installing and Setting Up JUNOScope Software for AIS

This chapter explains how to install and set up the JUNOScope software to integrate with Advanced Insight Manager (AIM) to:

- Import devices managed by JUNOScope
- Automatically install AI-Script to multiple devices at once

Figure 8 shows the sequence to install and set up the JUNOScope software.

Figure 8: Automatic AI-Script Install Package Installation Using JUNOScope Script Management

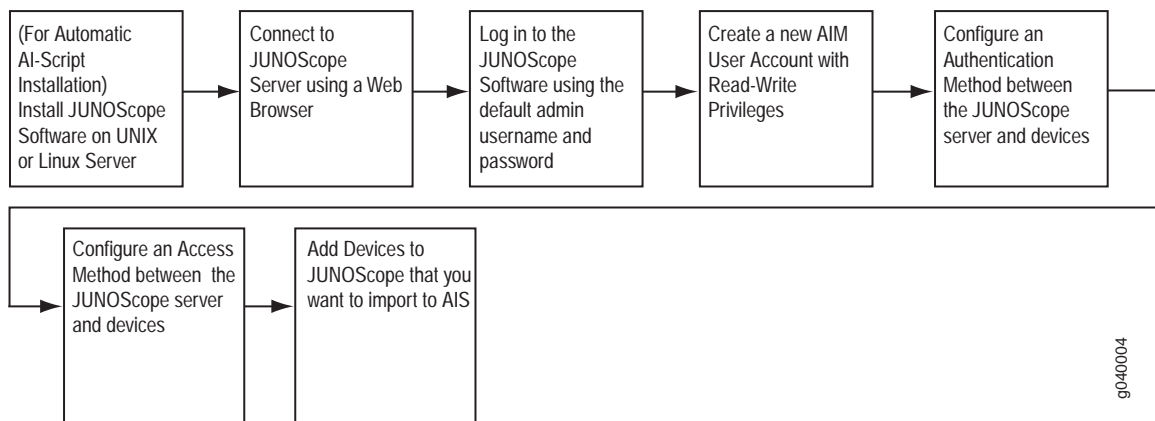

Install the JUNOScope software on the same server as the Advanced Insight Manager (AIM) application. Install JUNOScope software first. AIS requires JUNOScope 9.0 or later.

This chapter includes the following sections

- Installing the JUNOScope Software on page 22)
- Connecting to the JUNOScope Software on page 22
- Logging In to the JUNOScope Software on page 22)

- Adding an AIM User with Read-Write Privileges on page 22)
- Set Up an Authorization Method on page 22
- Set Up an Access Method on page 23
- Adding Devices on page 23

Installing the JUNOScope Software

To install JUNOScope 9.0 Software or later, see the chapter about installing the software in the *JUNOScope Software User Guide*. You can view the *JUNOScope Software User Guide* at www.juniper.net/techpubs/.

Connecting to the JUNOScope Software

After you have installed the JUNOScope software, connect to it using a supported Web browser, including Microsoft Internet Explorer 6 or Netscape Navigator 6 or later with JavaScript enabled. See the chapter about installing the software in the *JUNOScope Software User Guide*,

Logging In to the JUNOScope Software

Log into the JUNOScope software using the valid JUNOScope user name and login password. The username and password are the ones specified during installation. See the chapter about installing the software in the *JUNOScope Software User Guide*.

Adding an AIM User with Read-Write Privileges

Create an AIM user in JUNOScope with read-write privileges. You need to remember the AIM user name and password for AIM setup. See the chapter about setting up user local Authentication in the *JUNOScope Software User Guide*.)

Set Up an Authorization Method

Set up an authorization method in the JUNOScope software for the devices you want to add.

You can specify the authentication information (login and password for accessing a router) configured on a router for remotely connecting to that router from the JUNOScope software. The JUNOScope software supports secure sockets layer (SSL) and clear-text access protocols. We recommend that you set up authentication information and access methods before you set up routers. See the chapter about setting up authentication information in the *JUNOScope 9.0 Software User Guide*.)

Set Up an Access Method

Set up an access method in the JUNOScope software for the devices you want to add.

You can specify the access method (JUNOScript access protocol to connect to the JUNOScript server running on a router) configured on a router for remotely connecting to that router from the JUNOScope software. The JUNOScope software supports secure sockets layer (SSL) and clear-text access protocols. We recommend that you set up access methods before you set up devices. See the chapter about setting up an access method in the *JUNOScope Software User Guide*.

Adding Devices

Add devices in the JUNOScope software that you want to participate in AIS. The JUNOScope software currently supports J-series, M-series, MX-series, and T-series devices.

See the chapter about Setting Up Devices in the *JUNOScope Software User Guide*,

You can import devices managed by the JUNOScope software into the AIM software for automatic AI-Script install package installation.

